



OWNER'S MANUAL

EG UNIVERSAL CART

Model No. EX5502638816002 / PCG2505W

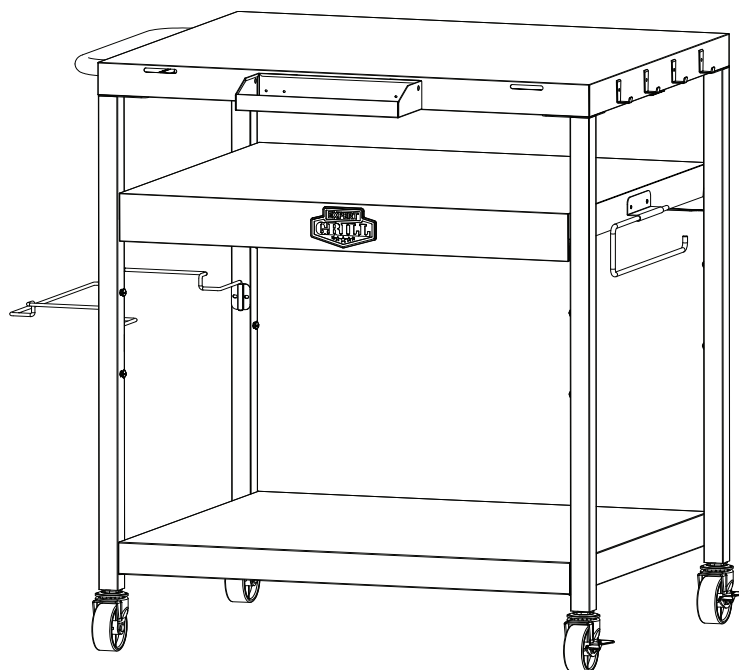

Table of Contents

Important Safeguards	Page 1
Expanded View & Hardwar	2
Assembly Instructions.	3
Operating Instructions.	6
Limited Warranty	6

This instruction manual contains important information necessary for the proper assembly and safe use of the appliance.

Read and follow all warnings and instructions before assembling and using the appliance.

Follow all warnings and instructions when using the appliance.

Keep this manual for future reference.



WARNING

FOR YOUR SAFETY:

For Outdoor Use Only! (outside any enclosure)



DANGER

1. Never exceed the maximum rated load values of this appliance.
2. This appliance is intended for use over flat surfaces only. Never use this appliance on inclines.
3. Children should not be left alone or unattended in an area where the appliance is being used. Do not allow them to sit, stand or play in or around the appliance at any time.
4. Do not store items of interest to children around or below the appliance.

Failure to comply with these instructions could result in serious bodily injury, death, or property damage.

Expanded View

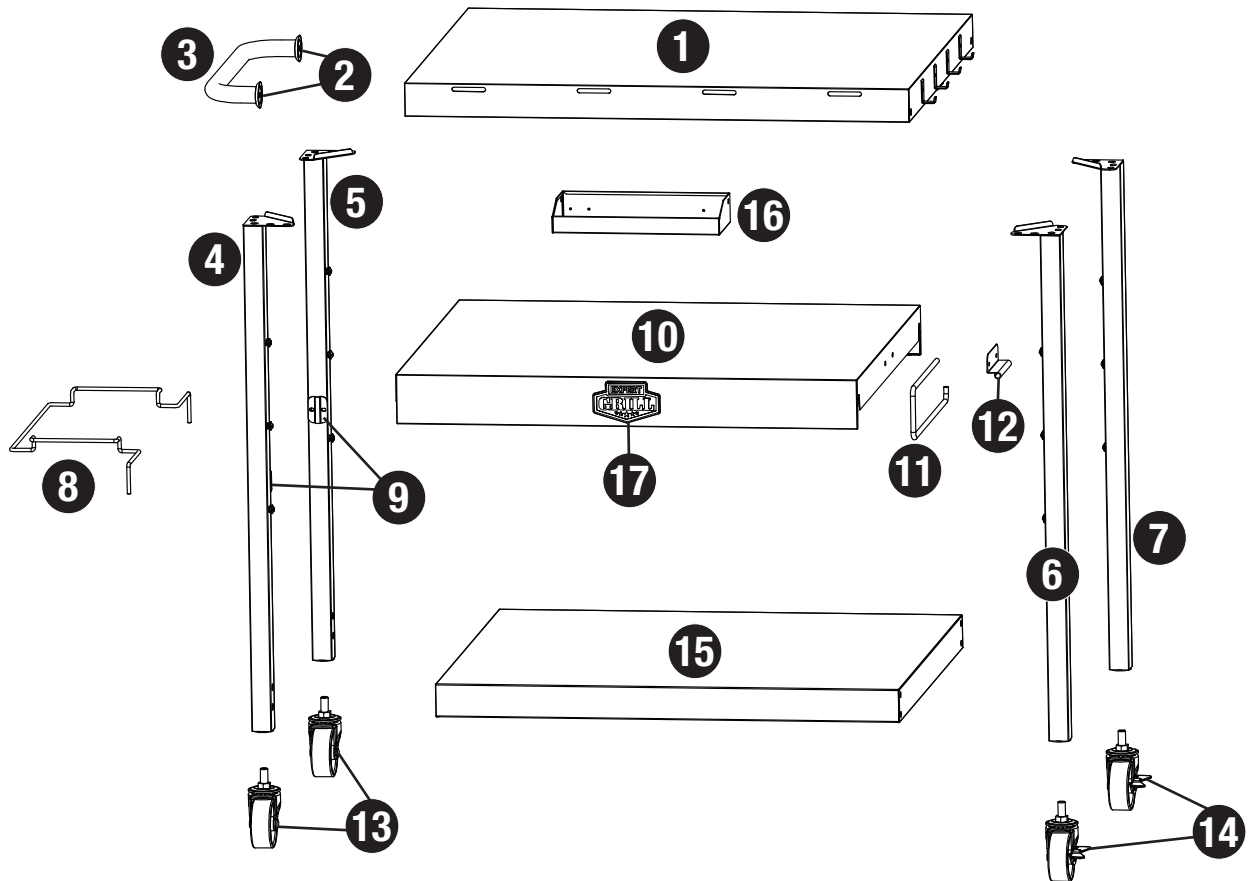

Parts List

1	Countertop	P2505-010	8	Trash Bag Holder	P2505-060	13	Unlocking wheel (2)	B0302-B02
2	Handle Seat (2)*	P2303-13C		Bracket for Trash		14	Locking wheel (2)	B0302-A01
3	Handle	P2303-14C	9	Bag Holder (2)*	P2303-15C	15	Bottom Panel	P2505-080
4	Left Front Leg	P2505-020	10	Middle Panel	P2505-070	16	Condiment Tray	P2303-07C
5	Left Rear Leg	P2505-030	11	Paper Towel Holder	P2303-05C	17	Brand (2)*	B0109-LBE
6	Right Front Leg	P2505-040		Bracket for Paper		* Pre-assembled		
7	Right Rear Leg	P2505-050	12	Towel Holder	P2303-06C			

Hardware

A	Screw	M4x12 Chrome Plated Phillips Truss Head	2 pcs
B	Screw	M6x15 Nickel Black Plated Phillips Truss Head	24 pcs

Tools Required for Assembly (Included)

Phillips Head Screwdriver	1 pc	M10 Wrench	1 pc

Assembly Instructions

3

DO NOT RETURN TO PLACE OF PURCHASE.

Please have your owner's manual and model number available for reference.

For Easiest Assembly:

1. Select an area where you will assemble this product. To protect components, choose a smooth surface that's free of cracks or openings.
2. Spread out all parts.
3. Tighten all hardware connections by hand first. Then, before completing each step, go back and fully tighten all hardware. Be careful not to overtighten. That could damage surfaces or strip threads.
4. For best results, complete each step in the order presented.

Typical assembly is approximately 20 minutes.

1

Remove Screws on Handle Pre-assembled

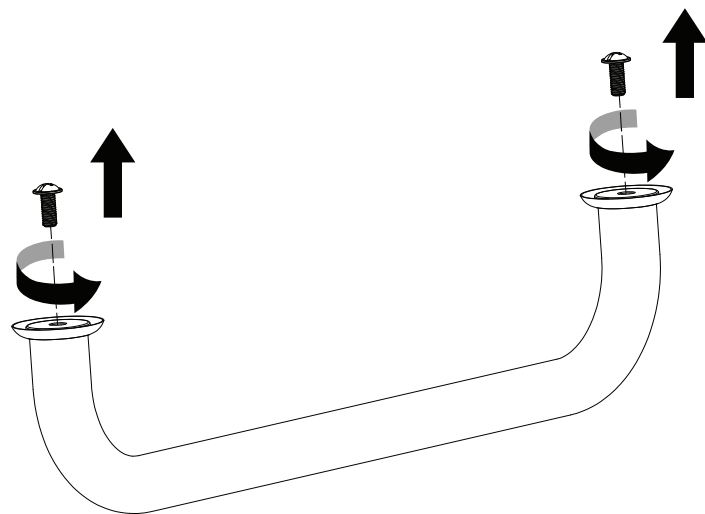

2

Attach Handle on Countertop

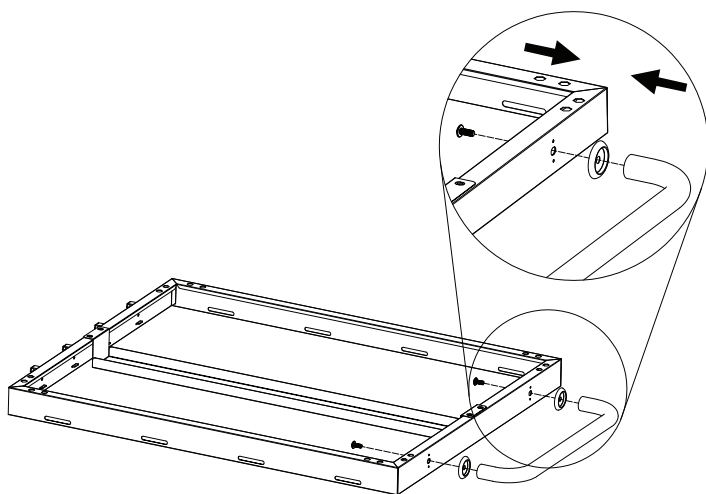

3

Attach Left Legs to Countertop

Note: The 2 brackets for trash bag holder should be faced each other.

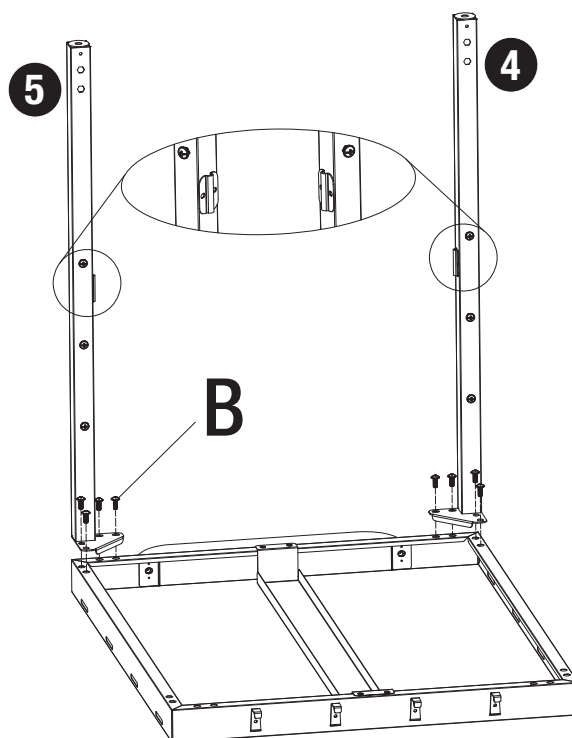

B

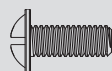

x 8

4 Attach Right Legs to Countertop

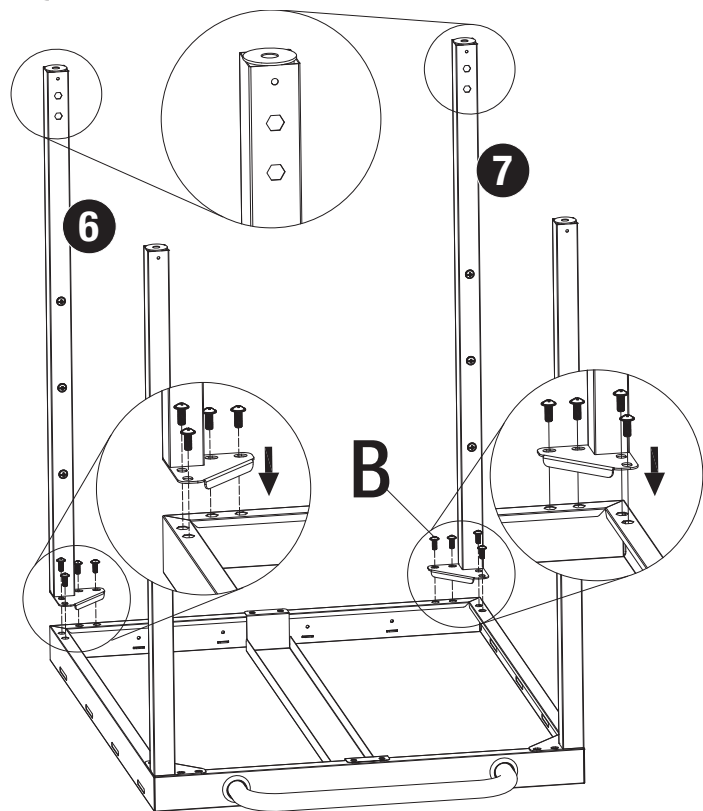

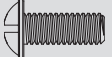
B  x 8

5 Attach Bottom Panel to Legs

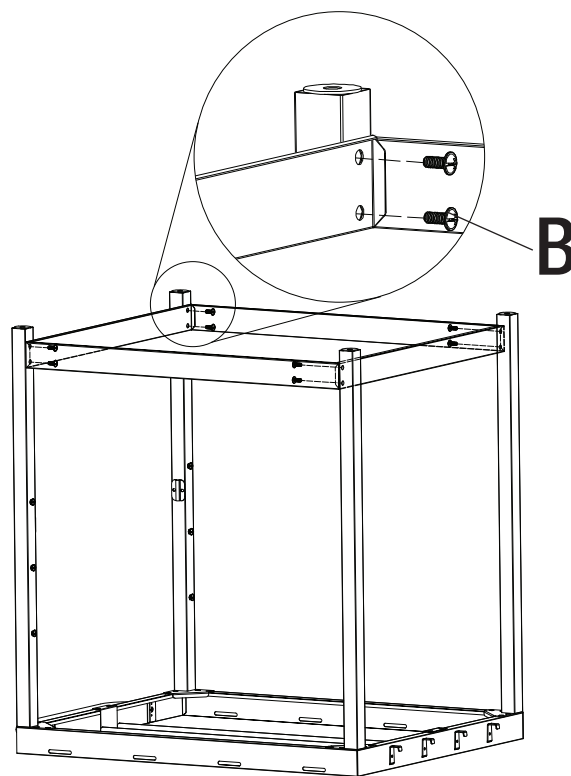

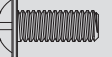
B  x 8

6 Insert and Fasten Wheels

Note: The 2 unlocking wheels and 2 locking wheels need be fastened by wrench included.

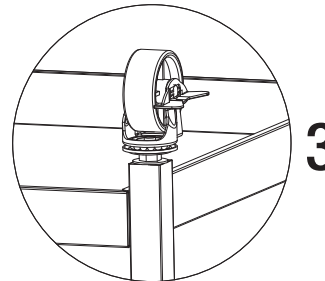
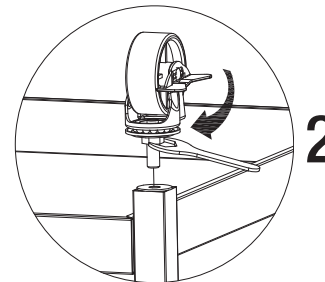
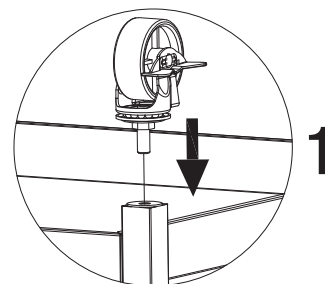
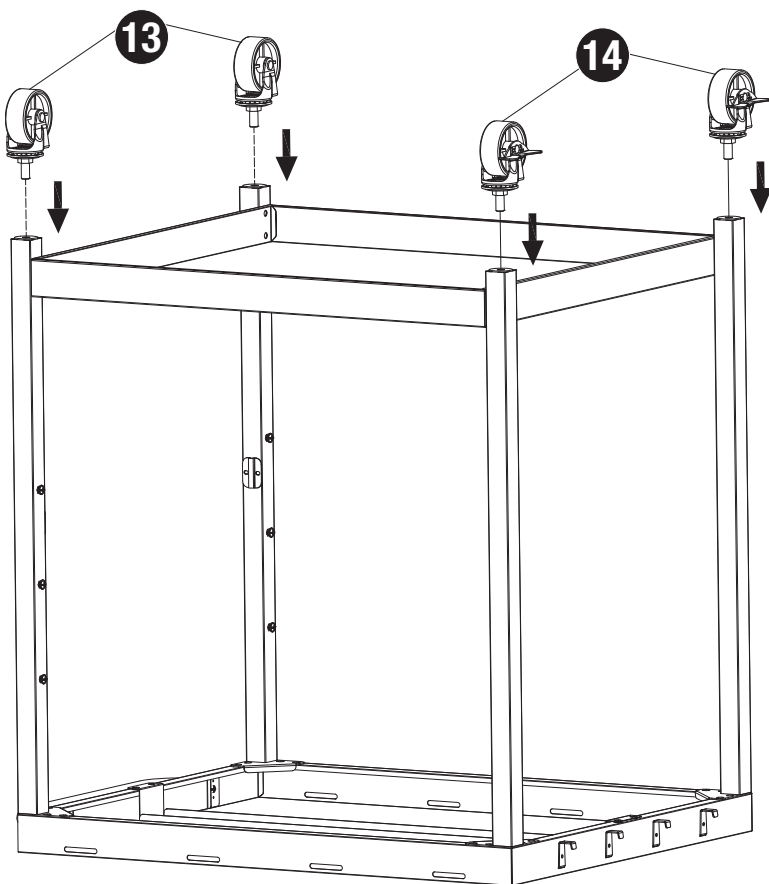

1

2

3

7 Attach Trash Bag Holder onto Left Legs

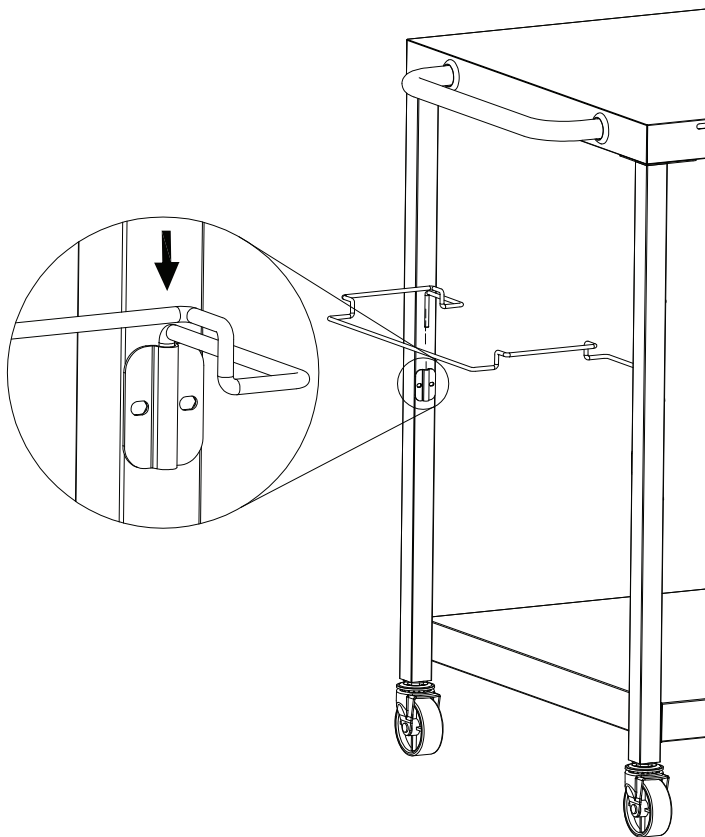

8 Attach Paper Towel Holder to Bracket for Paper Towel Holder

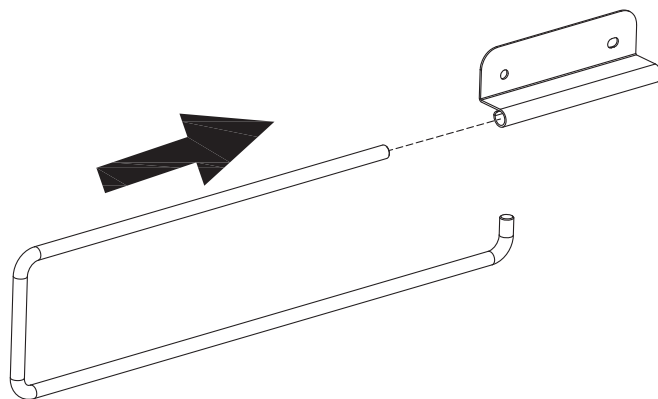

9 Place Middle Panel onto Screws Pre-Assembled on Legs and Attach Paper Towel Holder

Note: Middle panel can be adjusted in 3 levels.
Note: 2 Person required to adjust the middle panel.

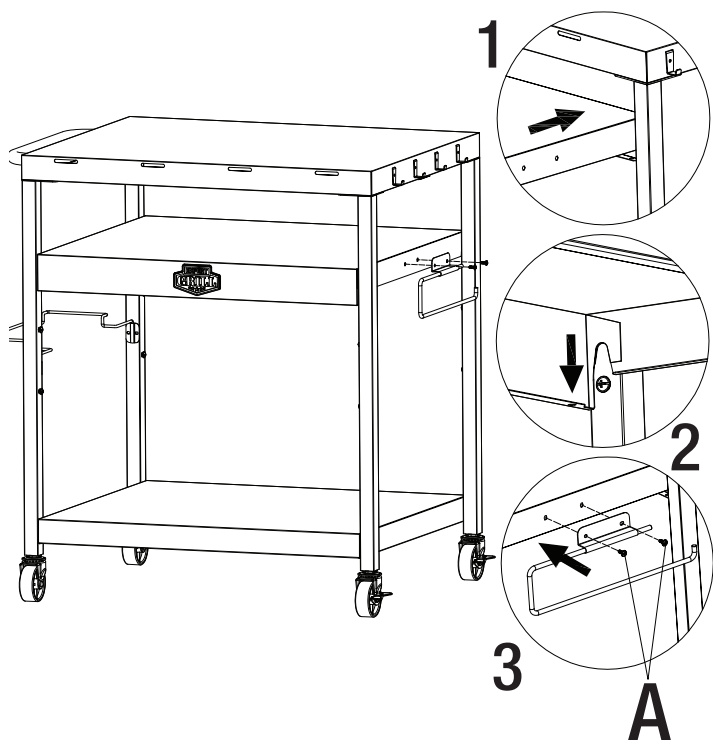

10 Insert Condiment Tray

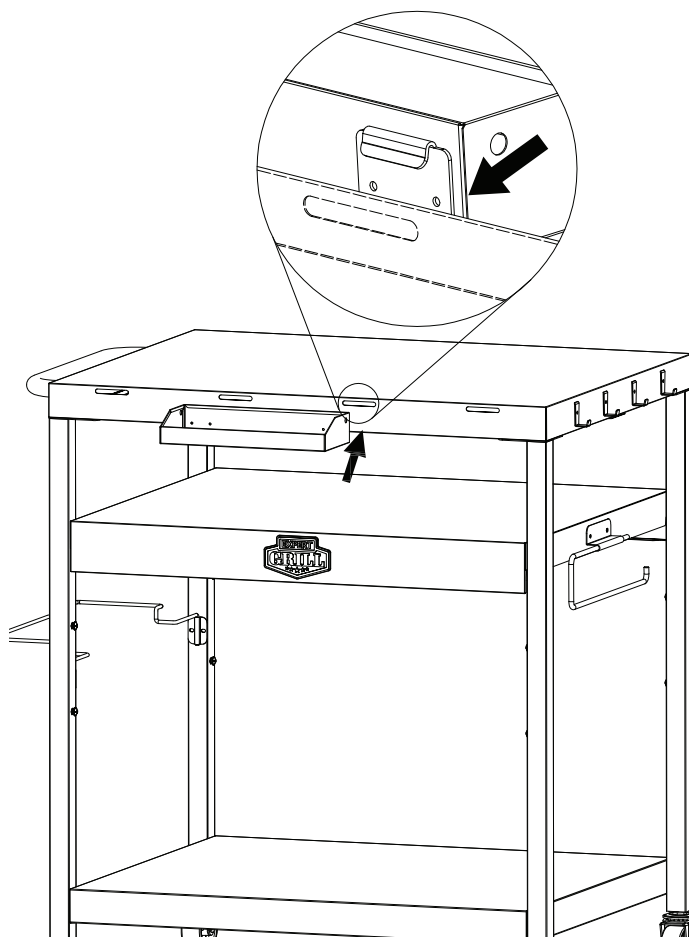

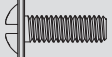
A  x 2

Operating Instructions

General Use of The Cart

Stainless steel countertop can be used for the preparation of food, while the middle and bottom metal shelves can be used for the storage or transportation of food, tools, etc.

Top shelf has 4 tool hooks of the purpose of hanging cooking tools or accessories.

A detachable condiment tray can be removed for storage or repositioned along the side of the countertop. Also included is a trash bag holder.

▲ WARNING: Do not exceed max loading capacity of 34 kgs (75 lbs.) for each shelf.

▲ WARNING: Do not exceed max loading capacity of 0.9 kgs (2 lbs.) for each tool hook.

▲ WARNING: Do not exceed max loading capacity of 2.3 kgs (5 lbs.) for condiment tray and for trash bag holder.

Important

Use only factory authorized parts. The use of any part that is not factory authorized can be dangerous. This will also void your warranty.

Keep this assembly and operating instruction manual for convenient reference.

Limited Warranty

RevoAce Inc. Limited ("RA") warrants to the original retail purchaser of this product, and to no other person, that if this product is assembled, maintained, and operated in accordance with the printed instructions accompanying it, then for a period of two (2) years for all remaining parts from the date of purchase, all parts in such product shall be free from defects in material and workmanship. RA may require reasonable proof of your date of purchase. Therefore, you should retain your sales slip or invoice. This Limited Warranty shall be limited to the repair or replacement of parts, which prove defective under normal use and service and which RA shall determine in its reasonable discretion upon examination to be defective. Before returning any parts, you should contact RA's Customer Care Department using the contact information listed below. If RA conforms, after examination, a defect covered by this Limited Warranty in any returned part, and if RA approves the claim, RA will replace such defective part without charge. If you return defective parts, transportation charges must be prepaid by you. RA will return replacement parts to the original retail purchaser, freight or postage prepaid. This Limited Warranty does not cover any failures or operating difficulties due to accident, abuse, misuse, alteration, misapplication, improper installation or improper maintenance or service by you or any third party, or failure to perform normal and routine maintenance on the product as set out in this owner's manual. In addition, the Limited Warranty does not cover damage to the finish, such as scratches, dents, discoloration, rust (SURFACE RUST IS NOT CONSIDERED A MANUFACTURING OR MATERIALS DEFECT) or other weather damage, after purchase.

This Limited Warranty is in lieu of all other express warranties. RA disclaims all warranties for products that are purchased from sellers other than authorized retailers or distributors, including the warranty of merchantability or the warranty of fitness for a particular purpose. RA ALSO DISCLAIMS ANY AND ALL IMPLIED WARRANTIES, INCLUDING WITHOUT LIMITATION THE IMPLIED WARRANTIES OF MERCHANTABILITY AND FITNESS FOR A PARTICULAR PURPOSE. RA SHALL HAVE NO LIABILITY TO PURCHASER OR ANY THIRD PARTY FOR ANY SPECIAL, INDIRECT, PUNITIVE, INCIDENTAL, OR CONSEQUENTIAL DAMAGES. RA further disclaims any implied or express warranty of, and assumes no responsibility for, defects in workmanship caused by third parties. This Limited Warranty gives the purchaser specific legal rights; a purchaser may have other rights depending upon where he or she lives. Some jurisdictions do not allow the exclusion or limitation of special, incidental or consequential damages, or limitations on how long a warranty lasts, so the above exclusion and limitations may not apply to everyone. RA does not authorize any person or company to assume for it any other obligation or liability in connection with the sale, installation, use, removal, return, or replacement of its equipment, and no such representations are binding on RA.

Walmart call center:

Service hours 7 days/week, 7:00 AM - 9:00 PM CST

Contact number: 1-833-908-2026

Manufactured in China for:

RevoAce Inc. Limited / Hong Kong, China